



x2



x1



x1



**Attwood Crescent, Wyken**  
**Offers in excess of £150,000**



**elite**  
property



A FANTASTIC TWO BEDROOM SEMI DETACHED BUNGALOW IN WYKEN. This home has a recently refitted kitchen, refitted shower room, two bedrooms, conservatory, and large garage. There is a lovely garden to the front and a small paved garden to the rear with access to the garage. Close to local amenities and bus routes.

- SEMI DETACHED
- NICE QUIET LOCATION
- CLOSE TO BUS ROUTES AND AMENITIES
- REFITTED KITCHEN
- CONSERVATORY
- SHOWER ROOM
- LARGE GARAGE
- EPC RATING E







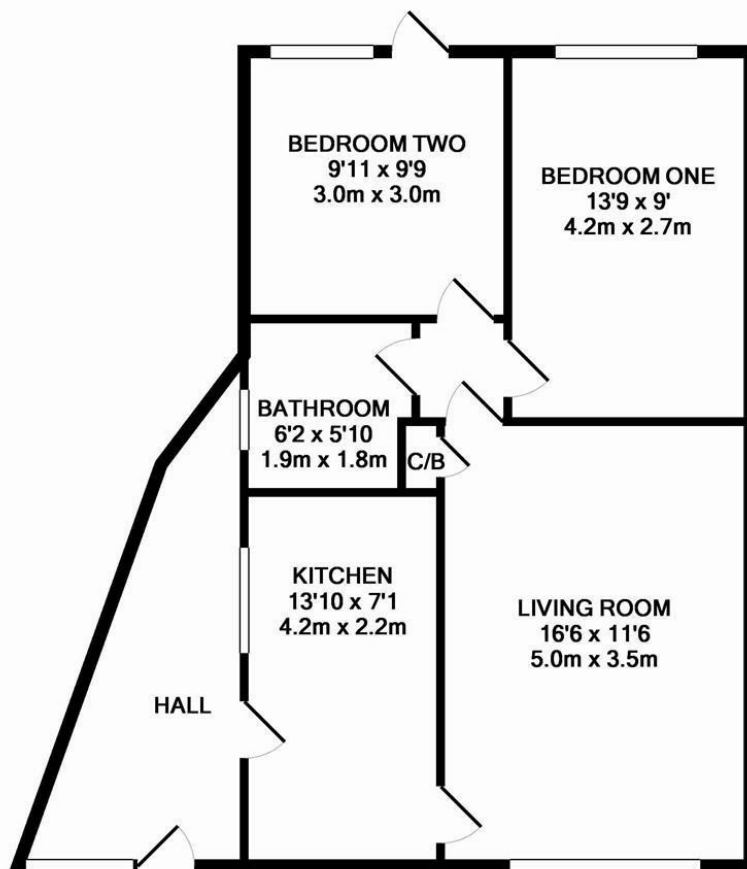

TOTAL APPROX. FLOOR AREA 658 SQ.FT. (61.2 SQ.M.)

Whilst every attempt has been made to ensure the accuracy of the floor plan contained here, measurements of doors, windows, rooms and any other items are approximate and no responsibility is taken for any error, omission, or mis-statement. This plan is for illustrative purposes only and should be used as such by any prospective purchaser. The services, systems and appliances shown have not been tested and no guarantee as to their operability or efficiency can be given  
Made with Metropix ©2016

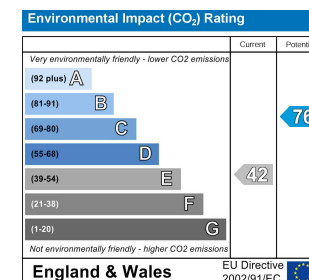
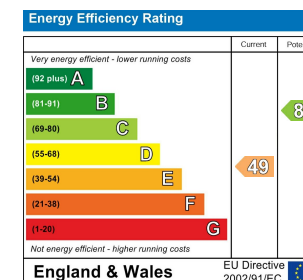

#### PLEASE NOTE: General Information

We have been informed by the vendor that the tenure of the property is Freehold. However, you are recommended to have this information verified by your legal advisor at the earliest opportunity. All measurements are approximate and quoted in metric and are for general guidance only and whilst every attempt has been made to ensure accuracy, they must not be relied on. The fixture, fittings and appliances referred to have not been tested and therefore no guarantee can be given that they are in working order. Internal photos are produced for internal general information and it must not be inferred that any item would be included within the sale.

**Elite Property Sterling House**  
**112 Walsgrave Road, Stoke, Coventry, CV2 4ED**  
**Tel: 024 7665 2200**  
**Email: [sales@eliteproperty.co](mailto:sales@eliteproperty.co)**  
**[www.eliteproperty.co](http://www.eliteproperty.co)**

**CALL US FOR A FREE, NO OBLIGATION, VALUATION TEL 024 7665 2200**

**Zoopla**.co.uk

**rightmove**.co.uk  
 The UK's number one property website

**PrimeLocation**.com