



Peldon Court, Sheen Road, TW9 1YU

£426,950 Leasehold

 3  1  1



Major
Son & Phipps

A beautifully presented 3 bedroom ground floor apartment with Juliette balcony, which is 0.7 miles to Richmond train/tube station and Richmond High Street.

The property has over 800 sq ft of light and spacious accommodation which includes a 17' living room with double French doors and Juliette balcony that enjoys leafy views of the communal gardens. All rooms are independently accessed from the entrance hall which has light oak flooring and an inner lobby area, there is also a light oak fitted kitchen and a smart contemporary shower room, with two double bedrooms and a further single bedroom/study.

Other benefits includes gas central heating, double glazing, plenty of storage (including double wardrobes to one of the main bedrooms) and security entry phone system.

Peldon Court is popular ex-council development consisting of three well maintained buildings with neatly looked after communal areas. The gardens surround the buildings with a large garden area to the rear of the property with mature trees and well screened from neighbouring buildings outside of the development, also to the front there is a communal parking to the front and bicycle racks.

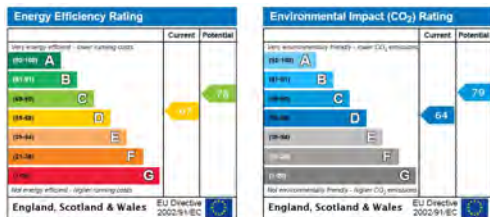

Peldon Court

Approximate Gross Internal Area = 75.8 sq m / 816 sq ft

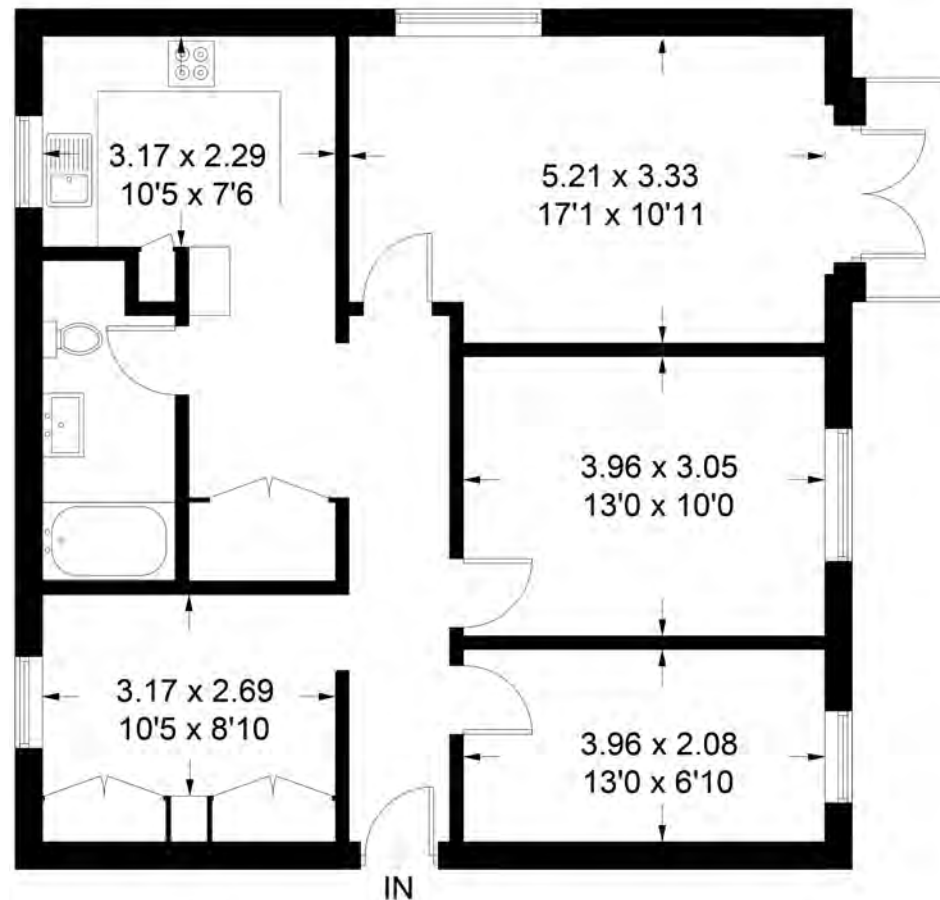

Contact us:

Tel 020 8940 2233

sales@majorsonphipps.com

www.majorsonphipps.com

Major Son and Phipps

Dome Buildings

5a The Square

Richmond

Surrey

TW9 1DX

Illustration for identification purposes only, measurements are approximate, not to scale. FloorplansUsketch.com © 2017 (ID349245)



Major
Son & Phipps

Major Son & Phipps give notice to anyone reading these particulars that: (i) these particulars do not constitute part of an offer or contract; (ii) these particulars and any pictures or plans represent the opinion of the author and are given in good faith for guidance only and must not be construed as statements of fact; (iii) nothing in the particulars shall be deemed a statement that the property is in good condition otherwise; we have not carried out a structural survey of the property and have not tested the services, appliances or specified fittings.